



# STADIUM- CHINATOWN SKYTRAIN STATION

590 Beatty Street, Vancouver, BC

RETAIL LEASING BROCHURE

**NICK FISHER**

Personal Real Estate Corporation

604.628.2581

[nick@sitings.ca](mailto:nick@sitings.ca)



**SITINGS REALTY LTD.**

[SITINGS.CA](http://SITINGS.CA) / 604.684.6767

1595 – 650 West Georgia Street, Vancouver, BC V6B 4N8



# PROJECT SUMMARY

Stadium-Chinatown SkyTrain Station is located in downtown Vancouver and sees approx. 28,530 riders daily. The station has 3 major access points: SE corner of Beatty St. & Dunsmuir, International Village and Pacific Blvd. The subject unit is located on the interior of the station next to Tim Horton's.

- Stadium-Chinatown Station is the closest SkyTrain station to BC Place and Rogers Arena, two major entertainment venues that host Vancouver's top professional sports teams, and concerts, tradeshow & events.
- There is a dense residential neighbourhood of over 12,000 people within 0.5 km of the site & the station will be the closest stop to the new "The Post" development, which includes a new Loblaws City Market and over 1 M SF of office including over 7,000 Amazon employees.
- Other traffic drivers in the neighborhood include International Village Mall, with a large movie theatre, and the Vancouver Community College Downtown Campus, and Costco.

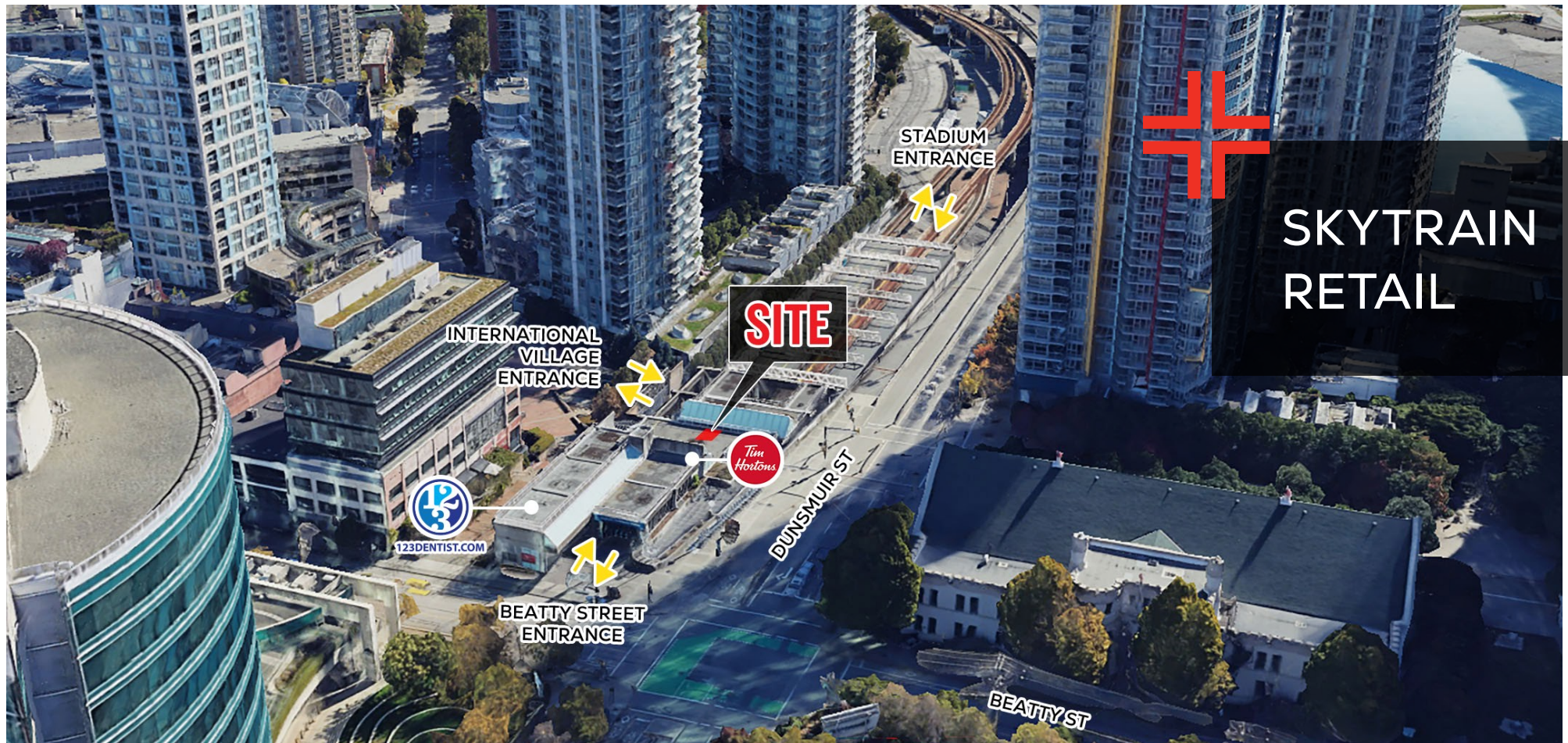

This document/email has been prepared by Sitings Realty Ltd. for advertising and general information only. Although information contained herein is from sources we believe reliable, Sitings Realty Ltd. makes no guarantees, representations or warranties of any kind, expressed or implied, regarding the information including, but not limited to, warranties of content, accuracy and reliability. This document/email is subject to errors and omissions and any interested party should undertake their own inquiries as to the accuracy of the information. Sitings Realty Ltd. excludes unequivocally all inferred or implied terms, conditions and warranties arising out of this document and excludes all liability for loss and damages arising there from. All areas, measurements and dimension herein are approximate, interested parties/tenant are to verify measurements if important to them. This document/email is not an inducement representation.

 **SITINGS**

**XTEAM**  
RETAIL ADVISORS

SITINGS.CA  
604.684.6767

## DETAILS

✦ CRU 1: 450 SF

✦ Join Tim Hortons & 123 Dentist (Coming soon)

✦ High traffic unit with prominent signage and move in ready improvements

✦ +28,530 avg. daily rider on & off boardings. Trains run every 2-3 minutes during peak hours

▶ VIRTUAL TOUR

✦ Available Immediately,  
Contact Listing Agent for Rent Details

## AREA TENANTS



## CONTACT

NICK FISHER

Personal Real Estate Corporation  
Sitings Realty Ltd

604.628.2581  
nick@sitings.ca



# T Key Regional Transit Connections

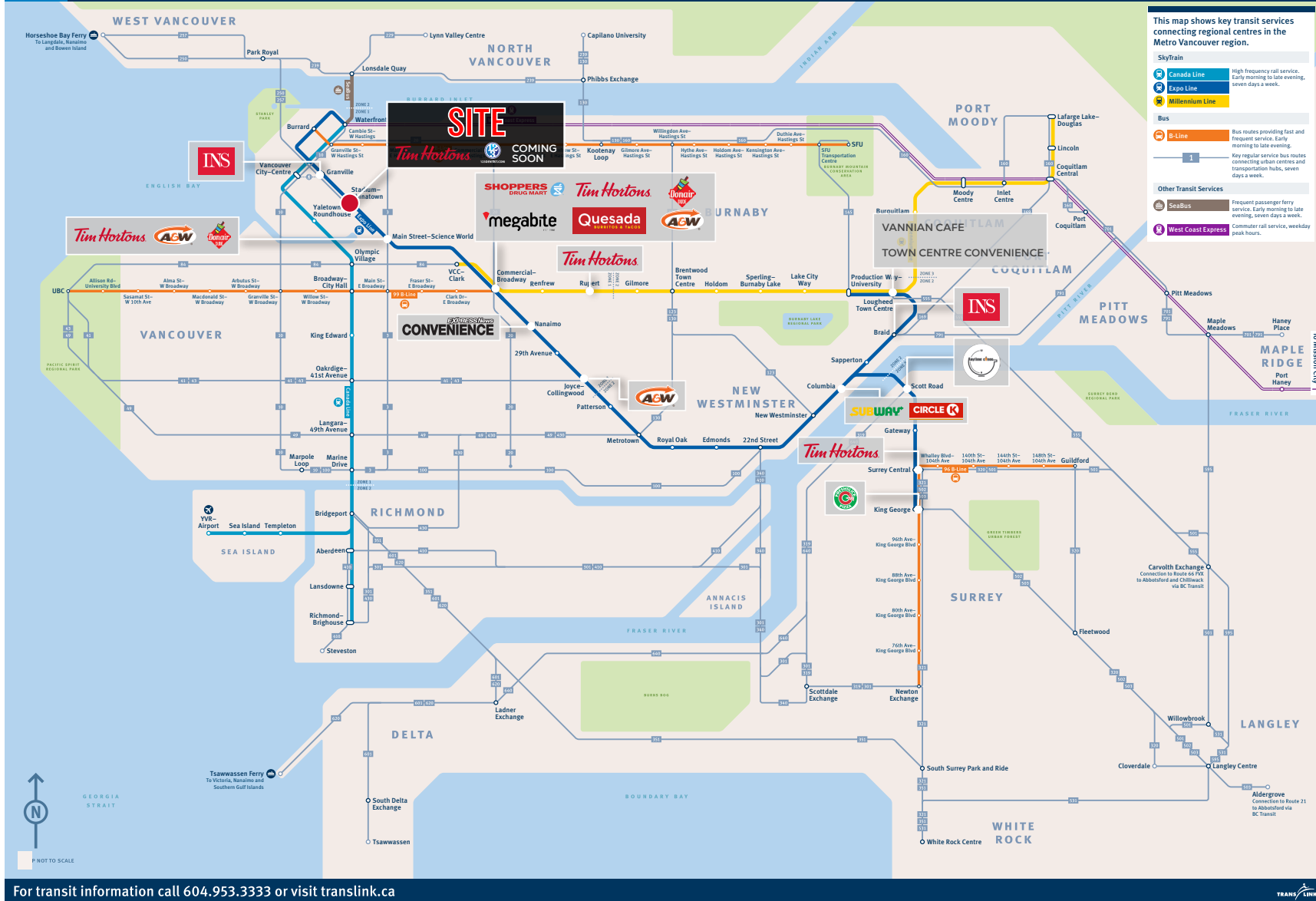

For transit information call 604.953.3333 or visit [translink.ca](http://translink.ca)



# STADIUM-CHINATOWN SKYTRAIN STATION

Vancouver, BC





# SITE PLAN

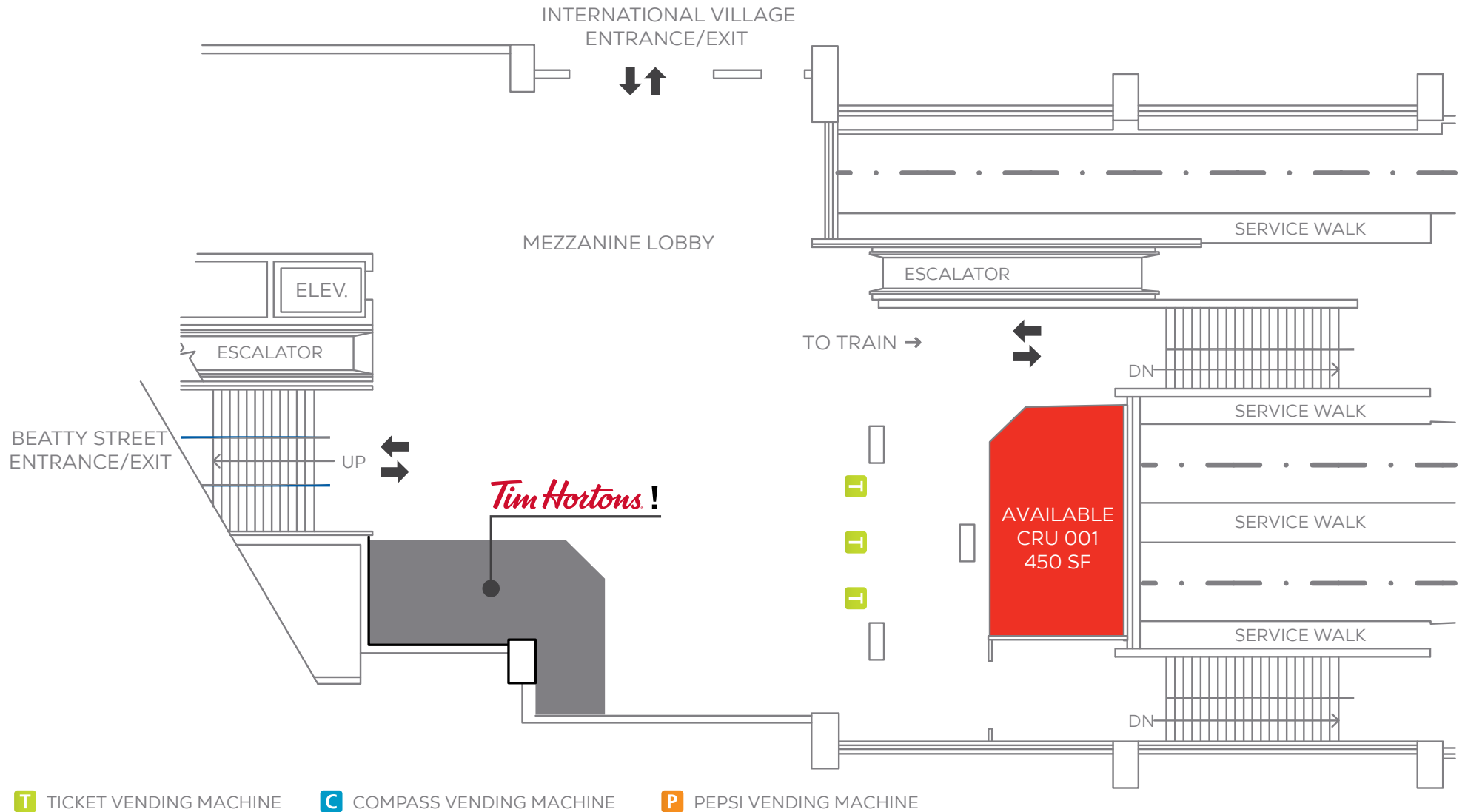





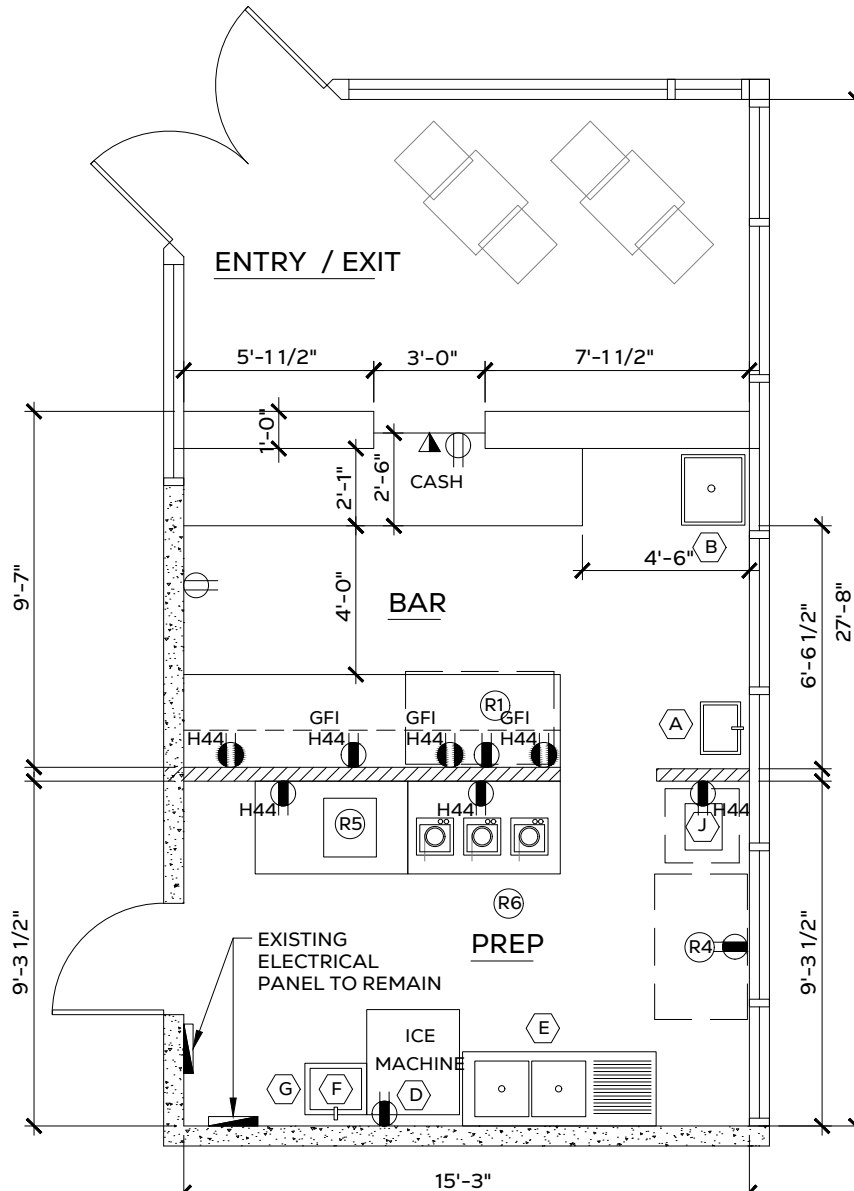

[VIRTUAL TOUR](#)

# FLOOR PLAN



## VIRTUAL TOUR

-  Millwork and granite countertop with cooler insert
-  1x double basin sink
-  1x single basin sink
-  Above floor grease trap
-  Hot water tank
-  Mop sink



## VIRTUAL TOUR

