



# WHISTLER'S MARKETPLACE

#123 - 4340 Lorimer Road  
Whistler, BC

RETAIL LEASING BROCHURE

**NANCY BAYLY**  
Personal Real Estate Corporation  
604.628.2580  
nancy@sitings.ca



**SITINGS REALTY LTD.**  
SITINGS.CA / 604.684.6767  
1595 - 650 West Georgia Street, Vancouver, BC V6B 4N8

# PROJECT SUMMARY

Exceptional opportunity to lease a 1,384 SF retail unit in the heart of Whistler Village Marketplace, the most desirable and accessible shopping centre in town.

Fresh St. Market, Rexall, Bosley's, Patagonia, and BC Liquor Store are just a few of the co-tenants in this prime location, attracting both locals and tourists alike + numerous additional amenities and convenient parking options just steps from the unit. Whistler is widely recognized as a top year-round resort destination, offering epic skiing across two mountains, unparalleled mountain biking, 4 golf courses, numerous hiking trails, and a vibrant village with unbeatable shopping, restaurants, and bars.

Take advantage of this incredible opportunity to grow your business in one of the world's most sought-after destinations!

# DETAILS

✦ Size: 2,623 SF TOTAL, demise option:

✦ Unit #126: under contract

✦ Unit #123: 1,384 SF - Available

✦ Available: Immediately (subject to demising)

✦ Central Village Location with Storefront Parking and Two Prominent Elevations of Signage

✦ Base Rent: Contact Listing Agent

Additional Rent: \$30.98 PSF (2025 est.)

✦ 281 Surface Parking Stalls + Whistler Day Lot Parking Nearby

✦ Dual frontage on Marketplace parking & Main Street

# AREA TENANTS

patagonia

FRESH ST. MARKET

Rexall

BCL BCLIQUOR



Artigiano

CIRCLE K

purebread



Tim Hortons

CIBC

Westland Insurance

bosley's  
BY PET VALU



# LISTING AGENT

NANCY BAYLY

Personal Real Estate Corporation  
Sitings Realty Ltd

604.628.2580

nancy@sitings.ca

# WHISTLER AERIAL



This document/email has been prepared by Sitings Realty Ltd. for advertising and general information only. Although information contained herein is from sources we believe reliable, Sitings Realty Ltd. makes no guarantees, representations or warranties of any kind, expressed or implied, regarding the information including, but not limited to, warranties of content, accuracy and reliability. This document/email is subject to errors and omissions and any interested party should undertake their own inquiries as to the accuracy of the information. Sitings Realty Ltd. excludes unequivocally all inferred or implied terms, conditions and warranties arising out of this document and excludes all liability for loss and damages arising there from. All areas, measurements and dimension herein are approximate, interested parties/tenant are to verify measurements if important to them. This document/email is not an inducement representation.

# WHISTLER VILLAGE MAP

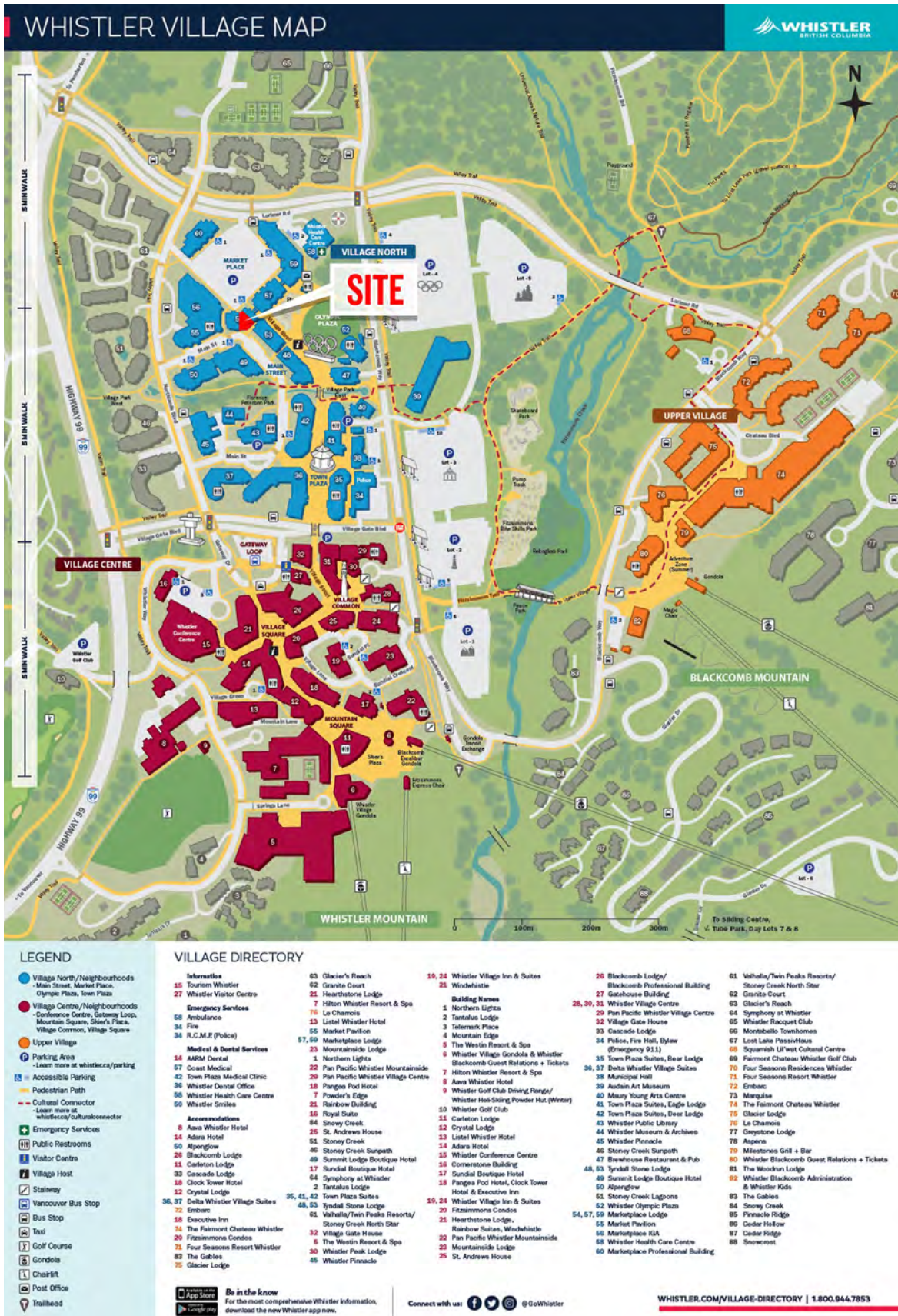

This document/email has been prepared by Sitings Realty Ltd. for advertising and general information only. Although information contained herein is from sources we believe reliable, Sitings Realty Ltd. makes no guarantees, representations or warranties of any kind, expressed or implied, regarding the information including, but not limited to, warranties of content, accuracy and reliability. This document/email is subject to errors and omissions and any interested party should undertake their own inquiries as to the accuracy of the information. Sitings Realty Ltd. excludes unequivocally all inferred or implied terms, conditions and warranties arising out of this document and excludes all liability for loss and damages arising there from. All areas, measurements and dimension herein are approximate, interested parties are to verify measurements if important to them. This document/email is not an inducement representation.

# TRADE AREA



## WHISTLER LOCAL POPULATION

14,367  
+ Over 400 Businesses

## ANNUAL VISITATION

3.3 Million  
(Approx. 45% Winter / 55% Summer)

## RESORT CAPACITY

35,000 Overnight Visitors  
Daily Population 35,000 - 70,000  
During Peak Times

# SITE PLAN



This document/email has been prepared by Sitings Realty Ltd. for advertising and general information only. Although information contained herein is from sources we believe reliable, Sitings Realty Ltd. makes no guarantees, representations or warranties of any kind, expressed or implied, regarding the information including, but not limited to, warranties of content, accuracy and reliability. This document/email is subject to errors and omissions and any interested party should undertake their own inquiries as to the accuracy of the information. Sitings Realty Ltd. excludes unequivocally all inferred or implied terms, conditions and warranties arising out of this document and excludes all liability for loss and damages arising there from. All areas, measurements and dimension herein are approximate, interested parties/tenant are to verify measurements if important to them. This document/email is not an inducement representation.

# FLOOR PLAN

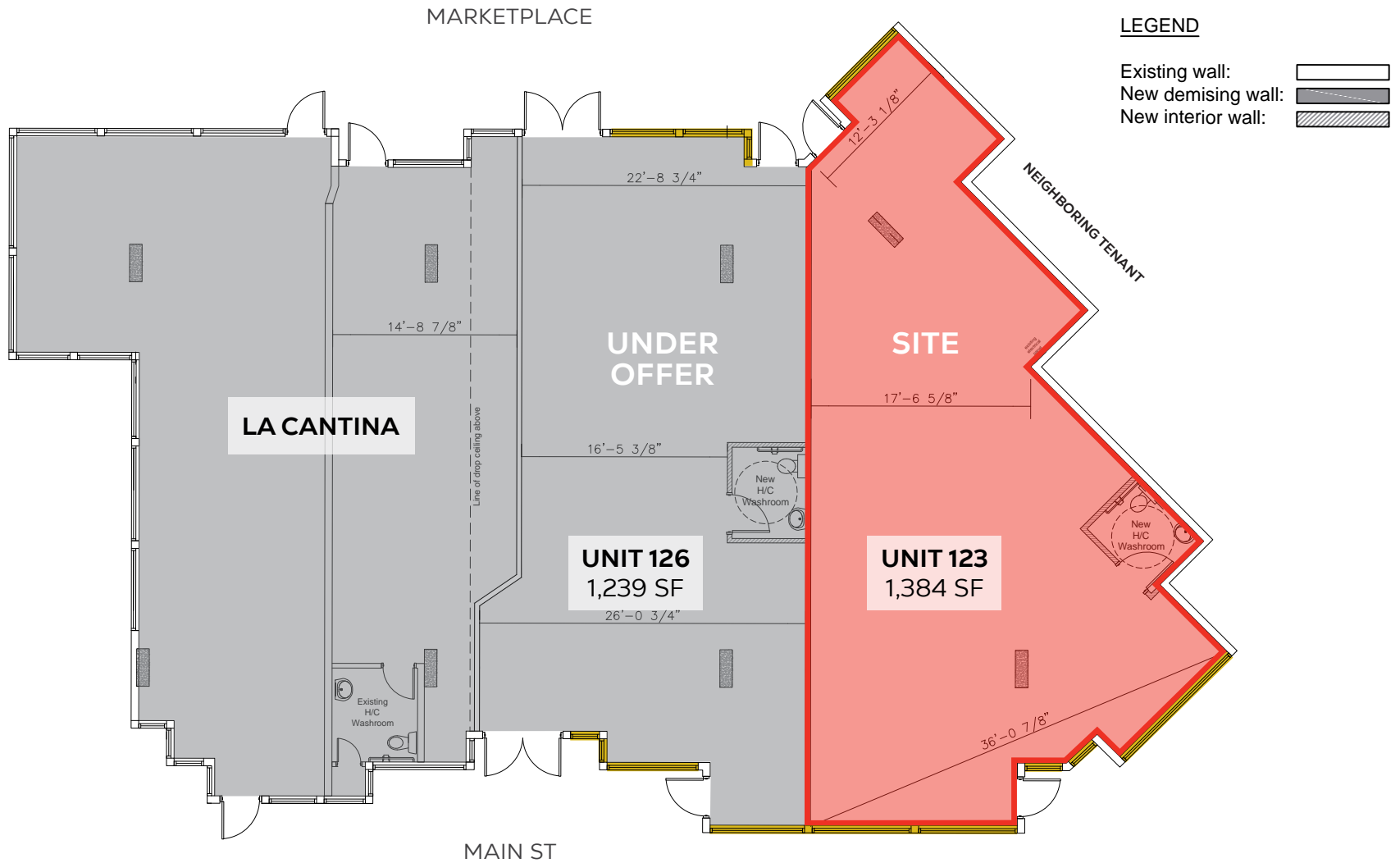

**GLAZING**

*Disclosure: The floor plan presented is for illustrative purposes only and should not be considered an accurate representation of final dimensions, measurements, or layouts. It is not intended for construction or reproduction of any plans*

# EXTERIOR PHOTOS





# WHISTLER EVENTS & CULTURE



Vibrant Village



Crankworkx

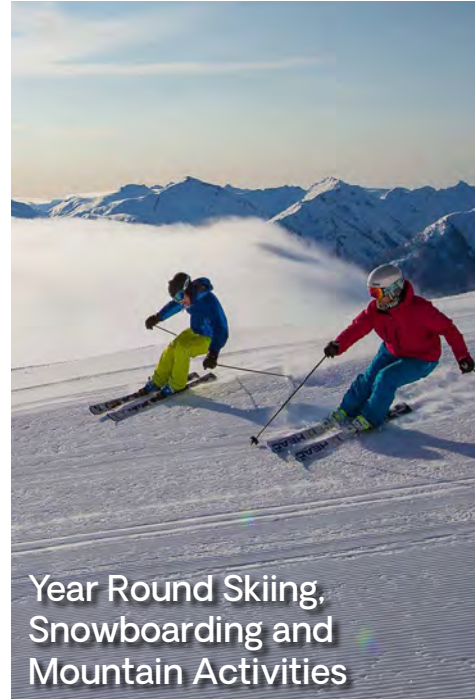

Year Round Skiing,  
Snowboarding and  
Mountain Activities



Beautiful Lakes



Whistler Ski &  
Snowboard Festival



Olympic Plaza  
Events & Outdoor Concerts



Nicklaus North, Whistler,  
Fairmont & Big Sky Golf  
Courses